

# CanCrete

## MODEL TYPE

Boom Pump Model  
Putzmeister M39-4

## BRICK COUNT

166 pcs



# The Concrete Way of Life (and Lego)

**CanCrete**

CanCrete first opened its doors in 2013, starting out as a small service centre in Etobicoke, Ontario. CanCrete now operates out of 4 locations, and services all Canadian provinces from coast to coast.

Although much has changed over the past decade, what remains true to this day is our dedication to you; we commit to delivering the latest and greatest in concrete pumping technology, and to providing exceptional service and support for your fleet.

We're excited to reveal our latest innovation – a new Putzmeister boom – in brick form! We hope you enjoy the build!

Thanks for choosing us to support your business; wishing you a prosperous 2025.

Sincerely,  
CanCrete Equipmentt



## **The Jack-Of-All-Trades**

Putzmeister's M39-4 Truck-Mounted Concrete Boom Pump comes equipped with a newly designed four-section Z boom that can either be permanent or detachable. It's a jack-of-all-trades that can perform typical and high-rise pumping applications as well as meet weight requirements during thaw season. We've listened to our user feedback and put it into action. Rather than purchasing three separate pieces of equipment, customers will benefit from the value of a single, customizable machine.

*Disclaimer: While realistic in appearance, this boom truck does not pump concrete.*

[www.CanCrete.ca](http://www.CanCrete.ca)

# Build Instructions:

Let's get to ~~work~~ play !

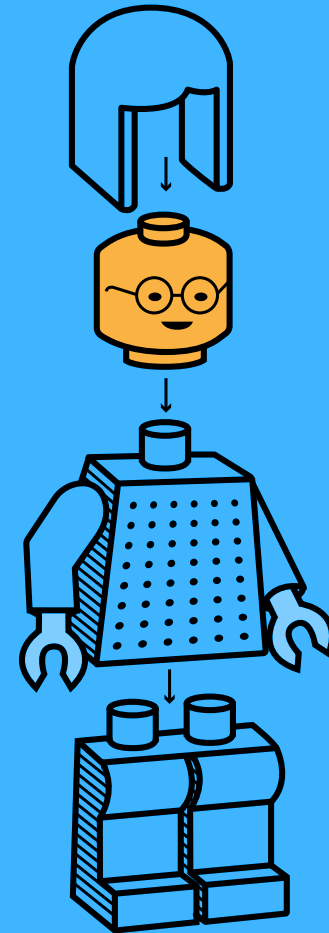

1

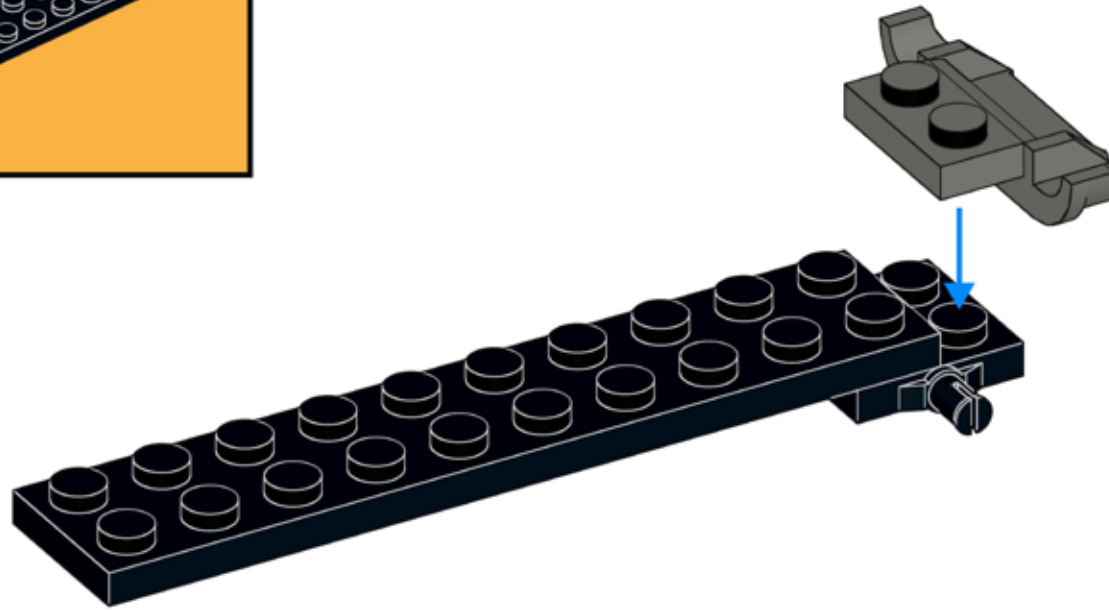
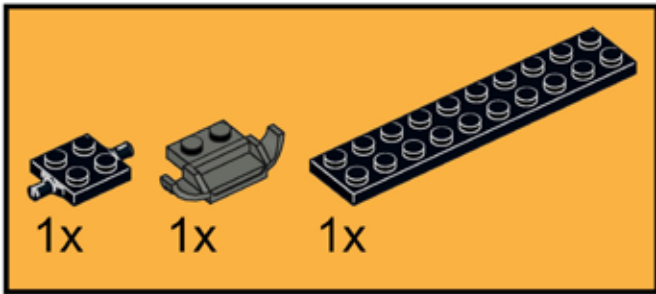

2

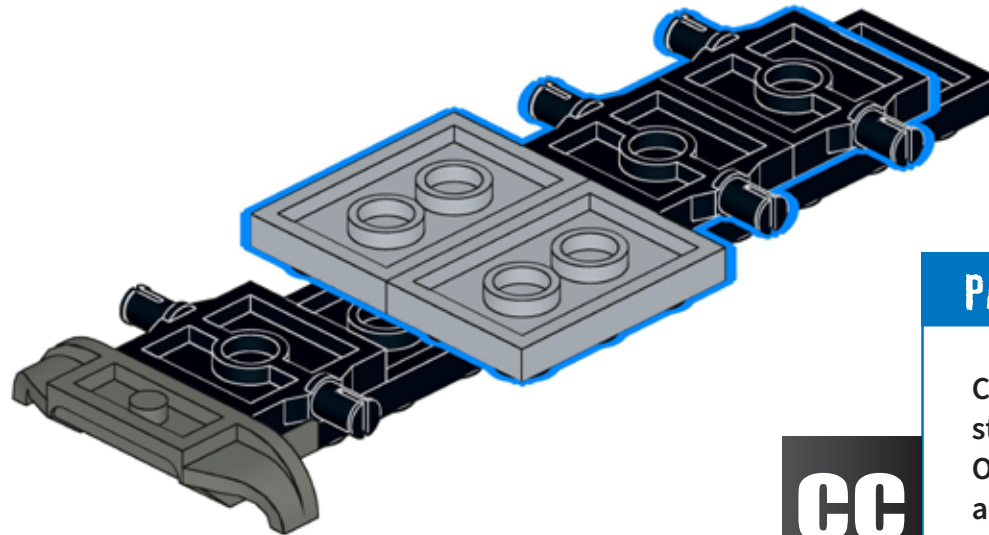
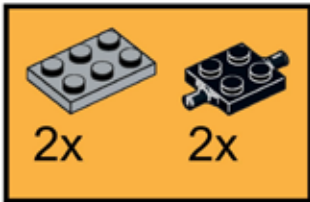

### PARTS MATTER!

CanCrete's parts van is fully stocked with commonly used OEM parts, and offers fast delivery across Southern Ontario.



3

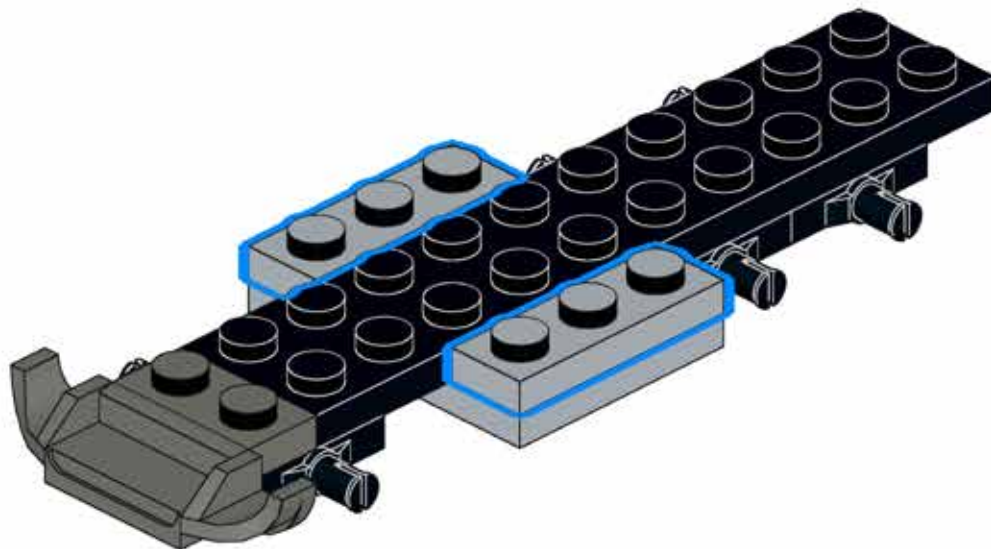
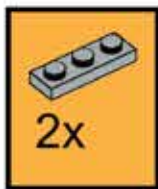

4

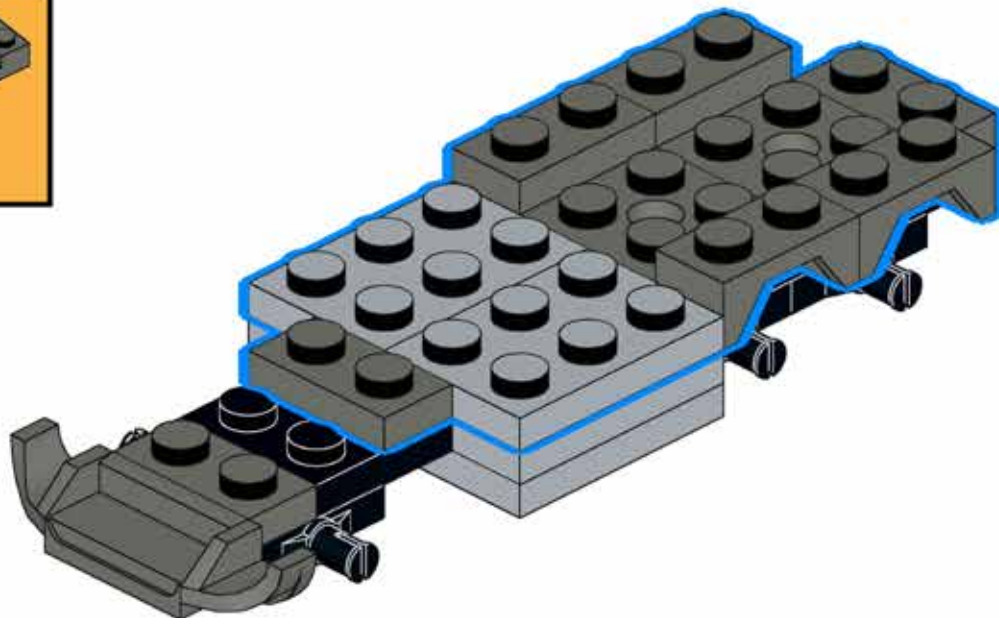
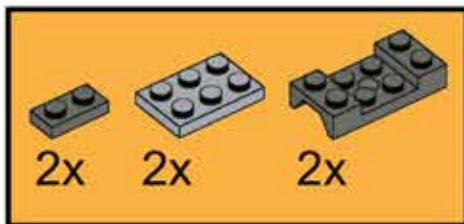

5

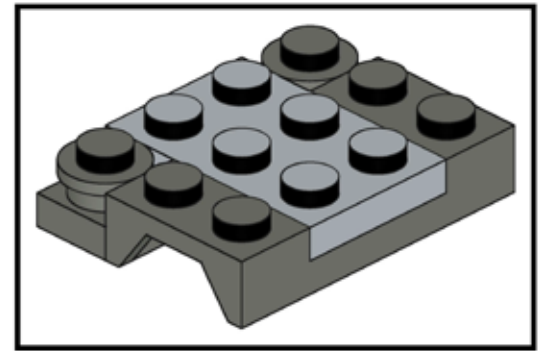
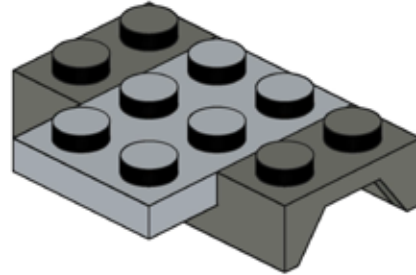
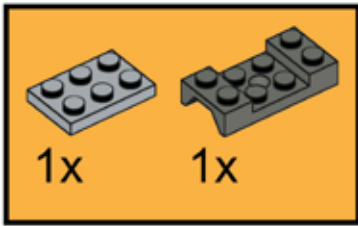

6

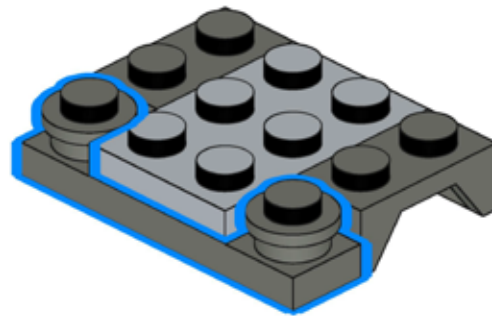
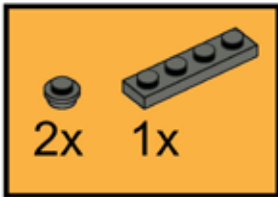

**FACT...**

CanCrete is Canada's exclusive Putzmeister dealer, offering a wide range of equipment including concrete boom pumps, trailer pumps, high-rise concrete placing systems, shotcrete pumps, and grouting equipment



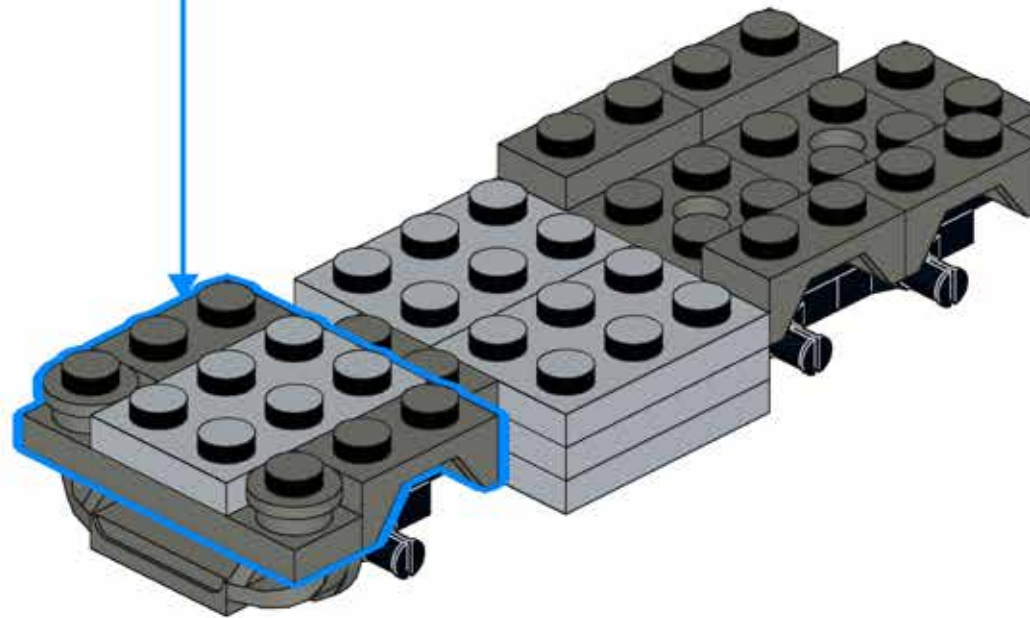

## KEEP IT RUNNING



Before Winter hits, it's important to service your slewing gearbox. This gearbox collects moisture from condensation over the year. If you don't change it before the temperatures drop below zero, the water freezes and damages the gearbox or causes the slewing function to stop operating.



8

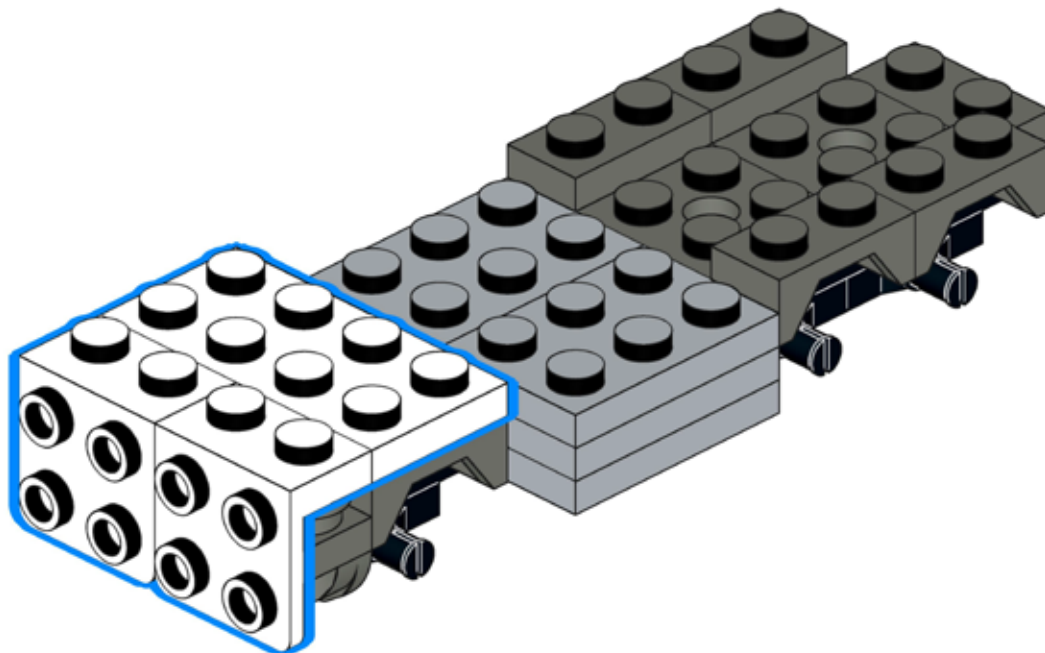
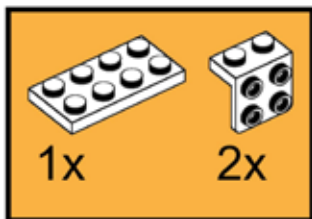

9

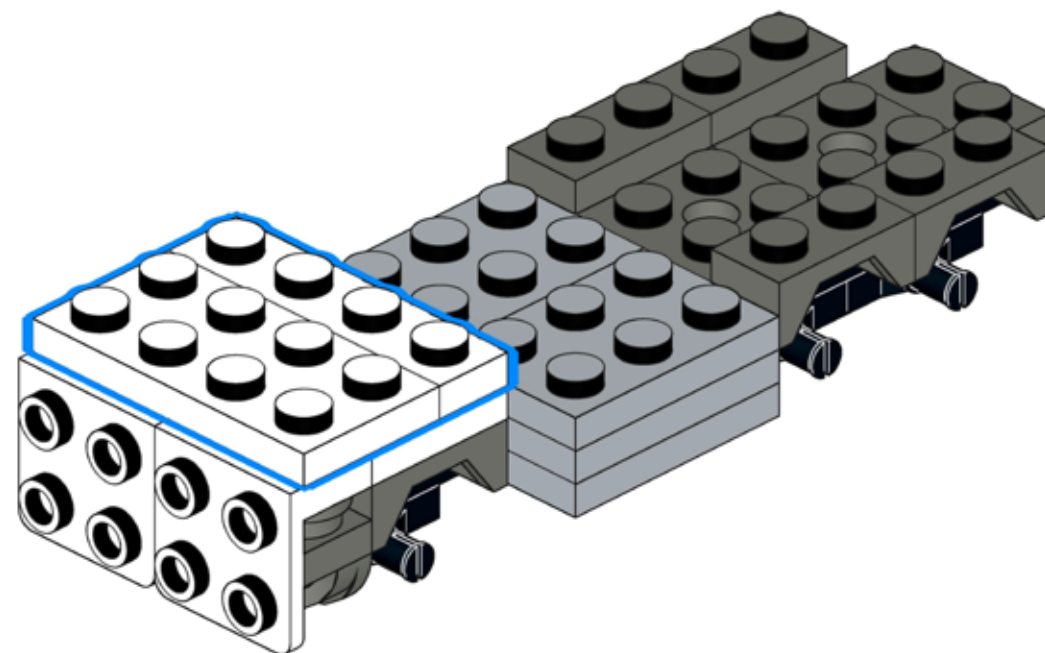
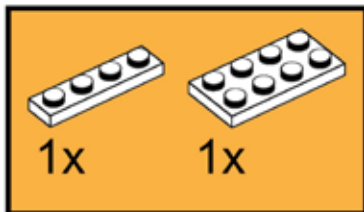



10

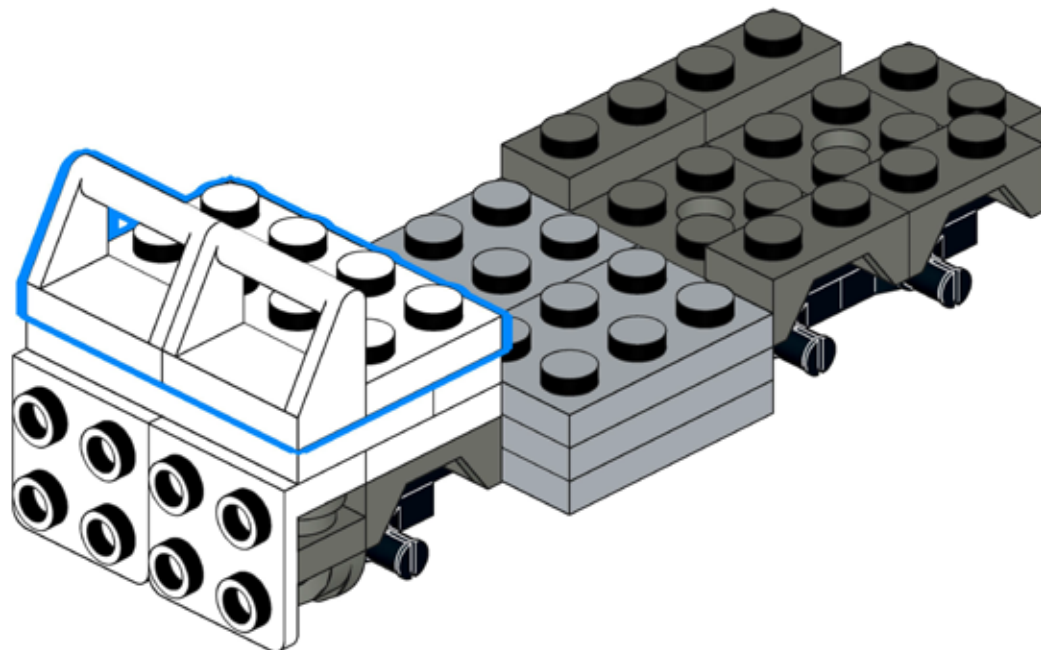
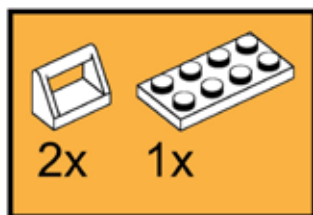

11

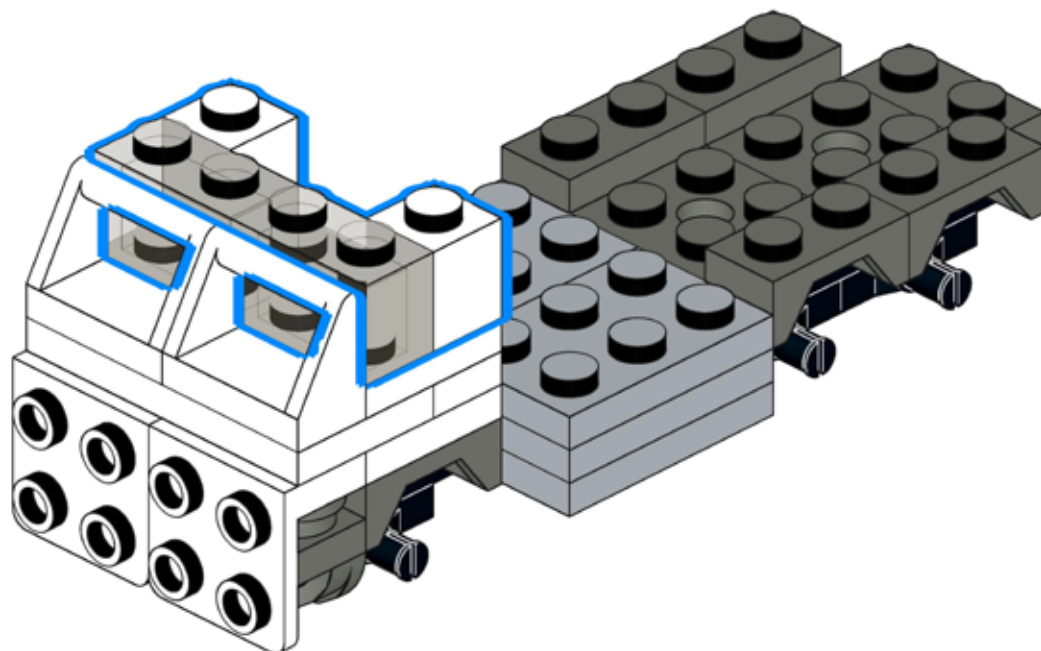
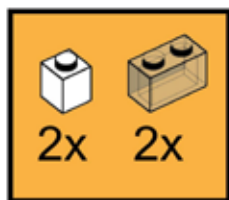

12

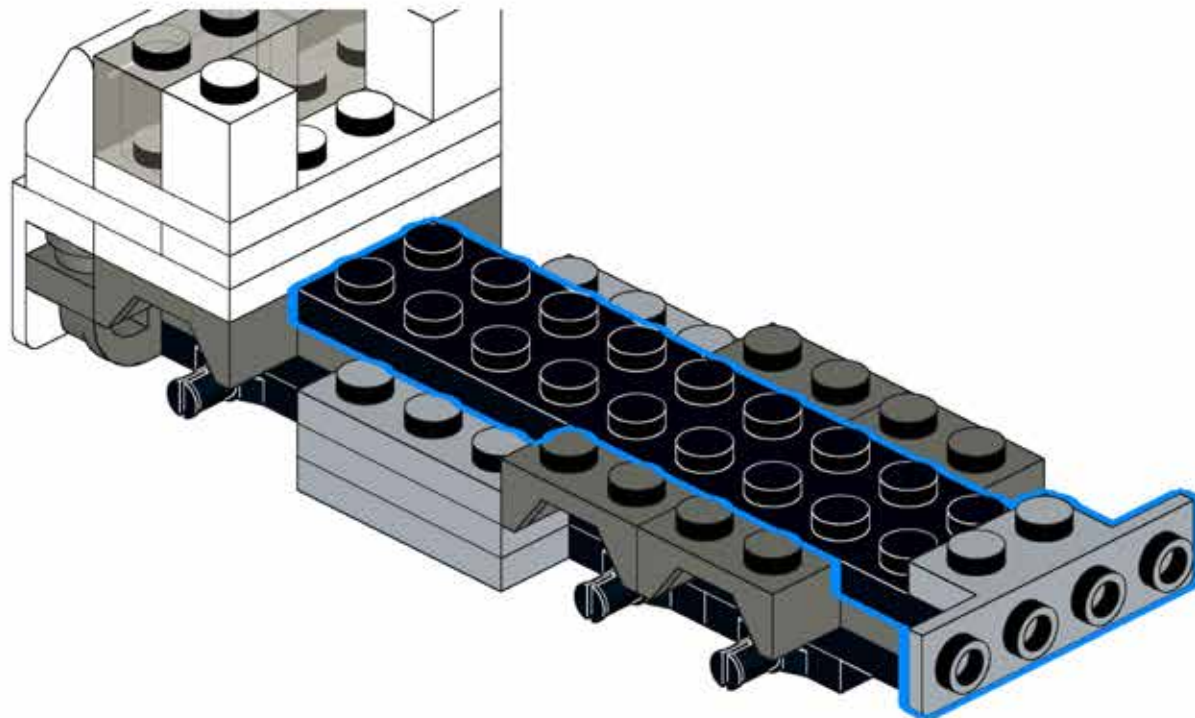
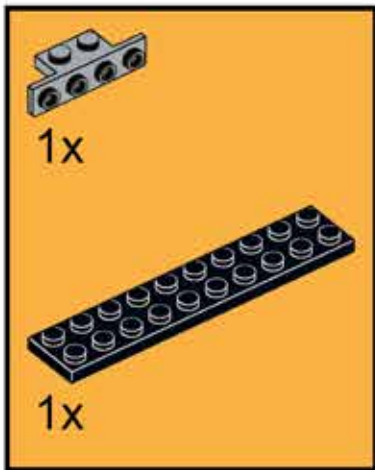

13

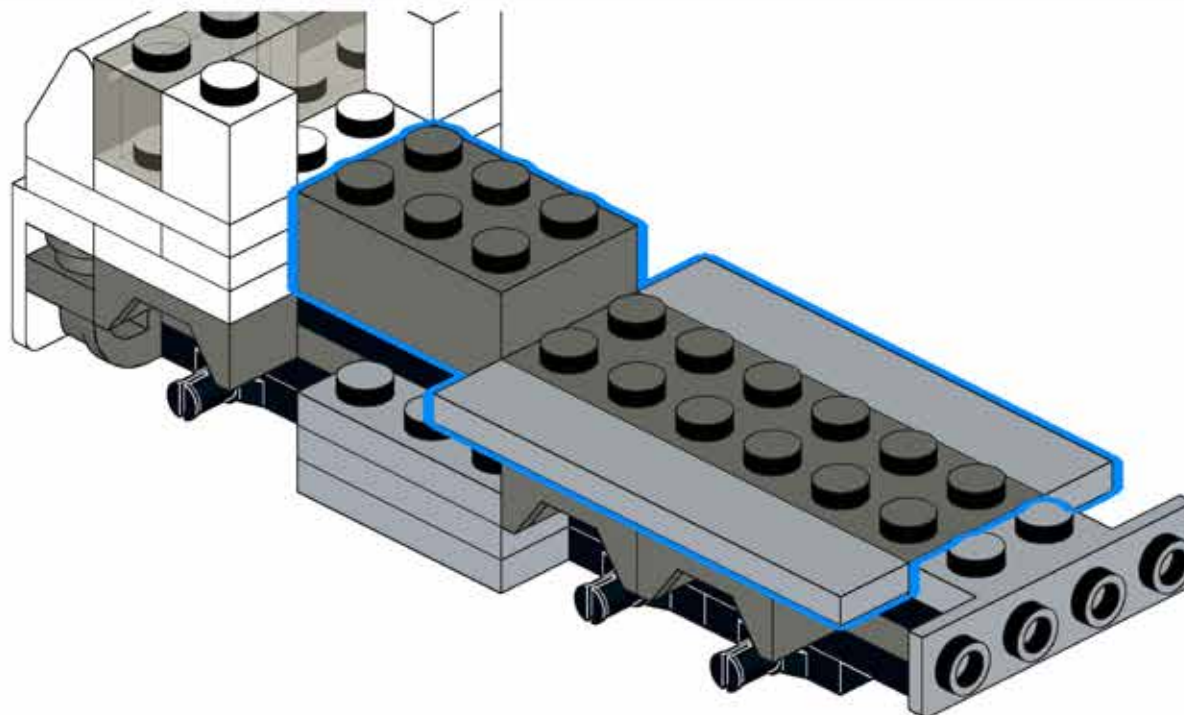
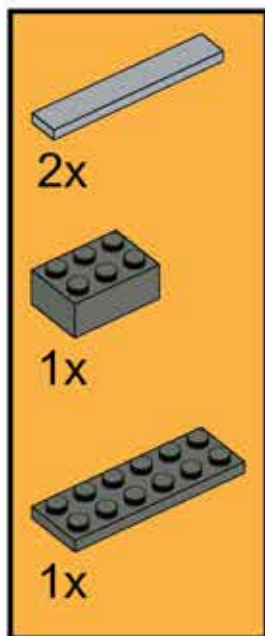

14

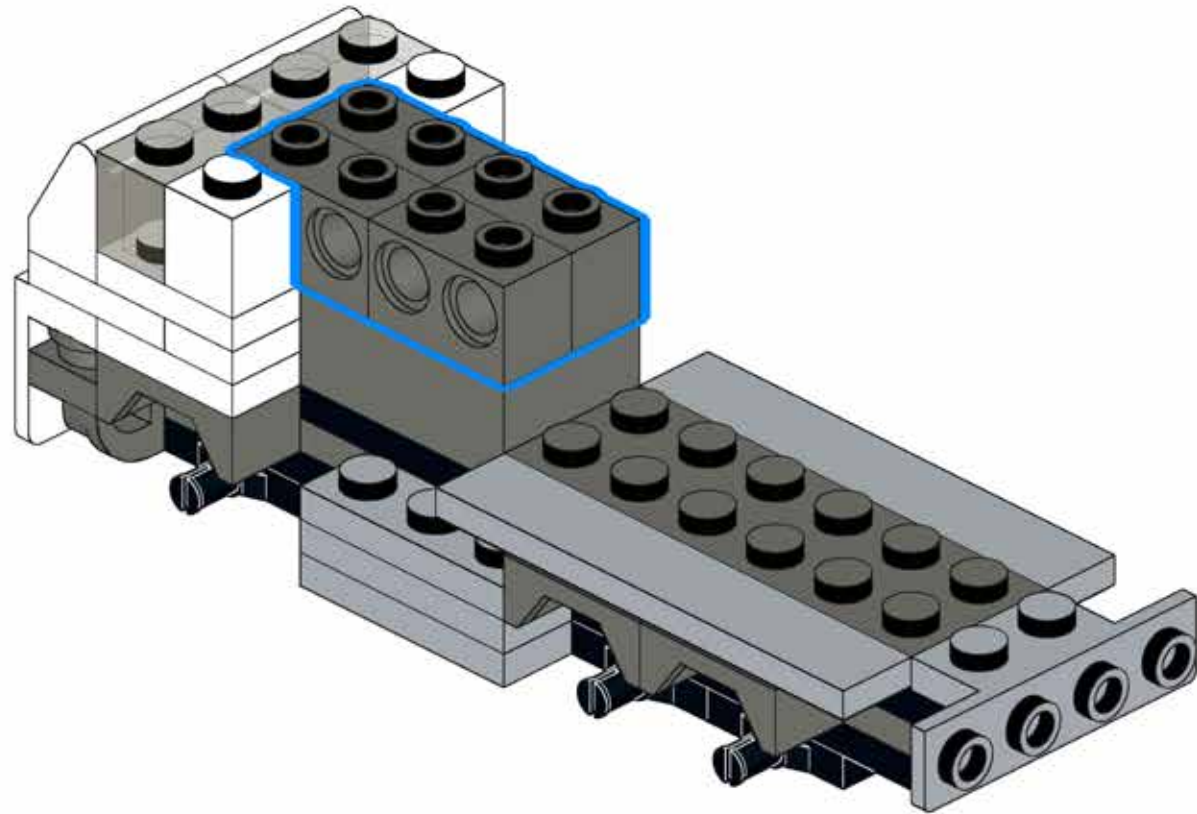

### FACT...

Karl Schlect (1932-2024) founded Putzmeister in 1958, in Aichtal, Germany. Over the course of 50+ years, he pioneered technological development in concrete pumping.



15

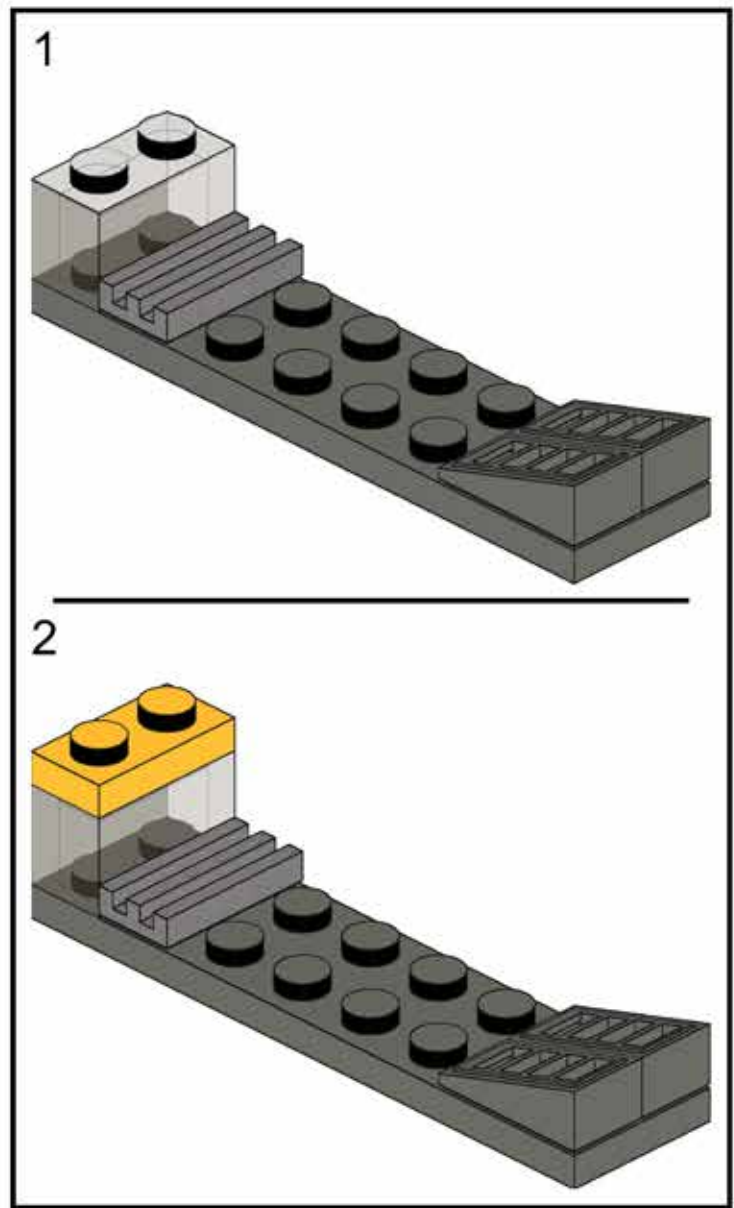
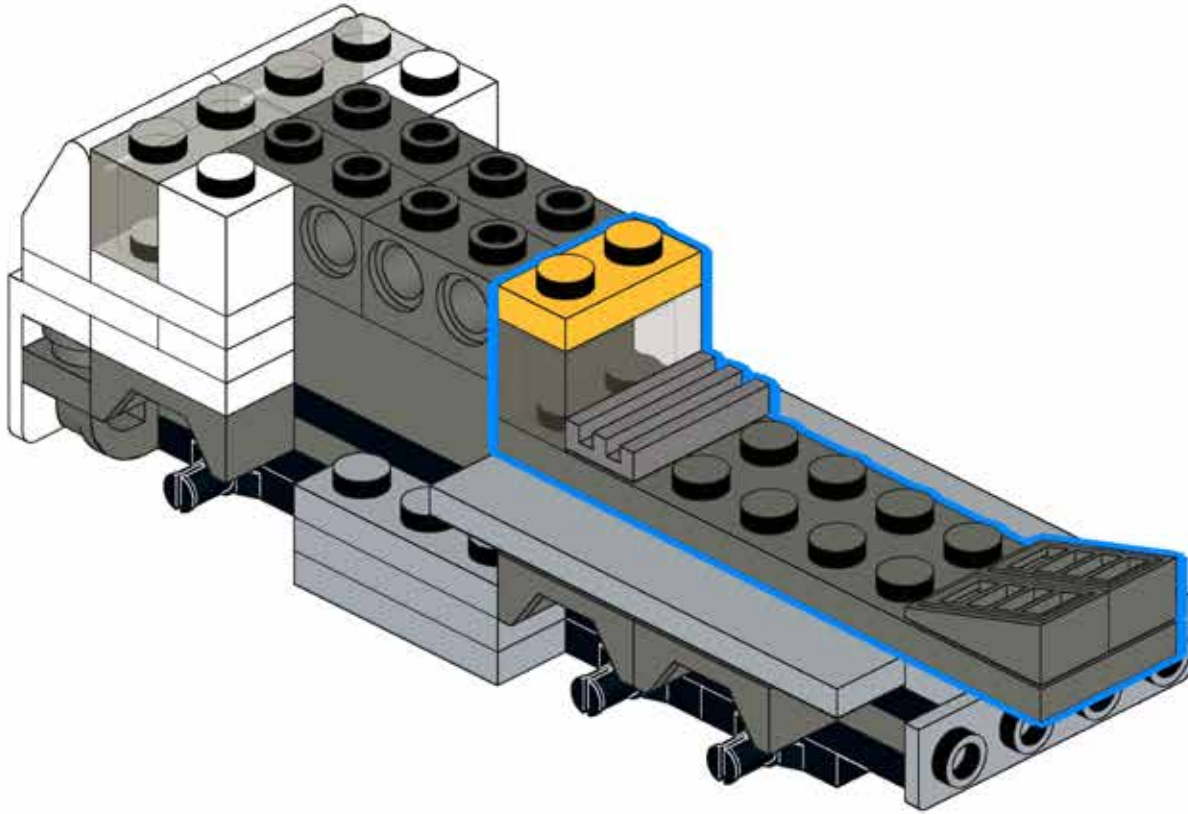
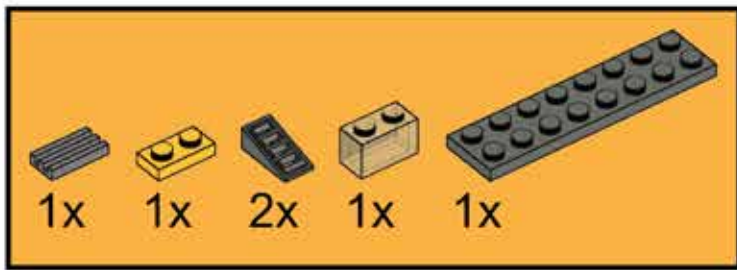

## KEEP IT RUNNING



As per manufacturer recommendations, hydraulic oil filters should be replaced every 500 pumping hours.





17

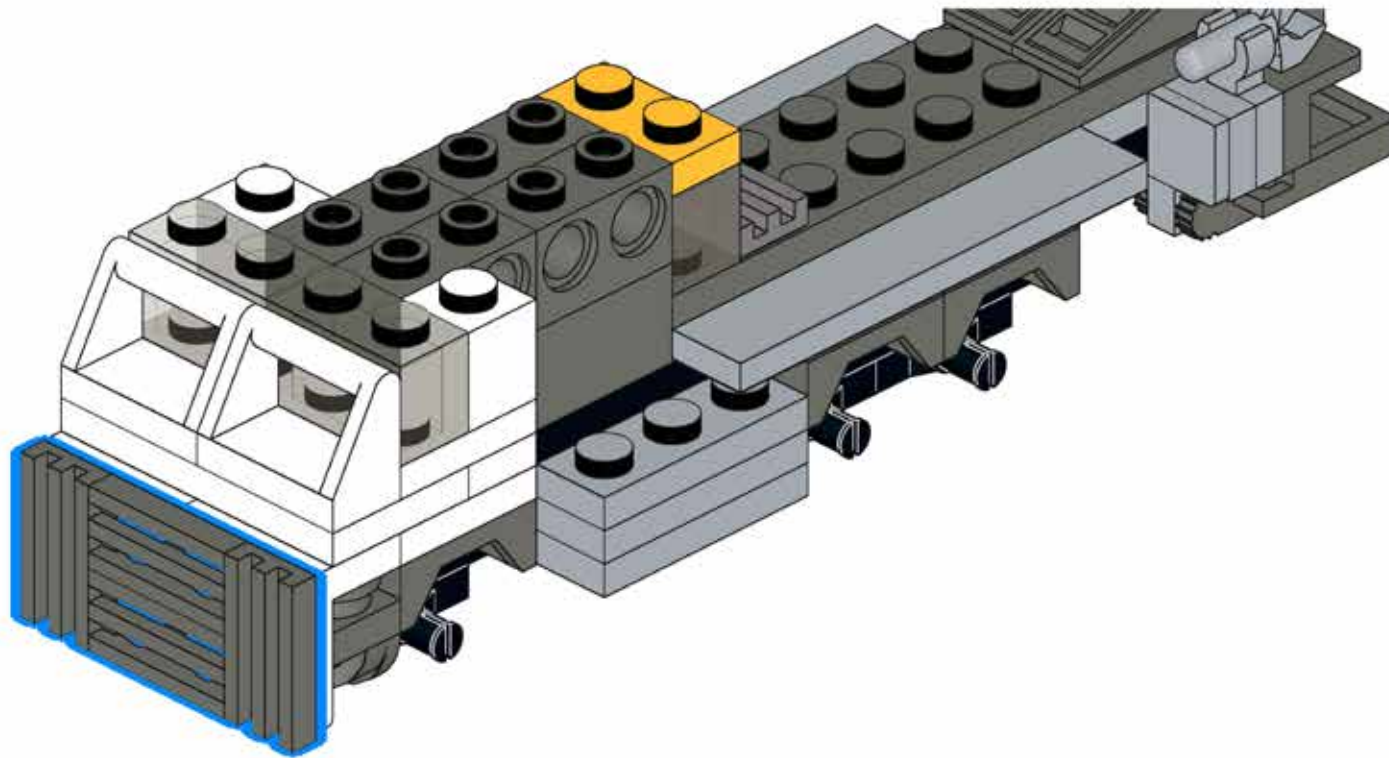

18

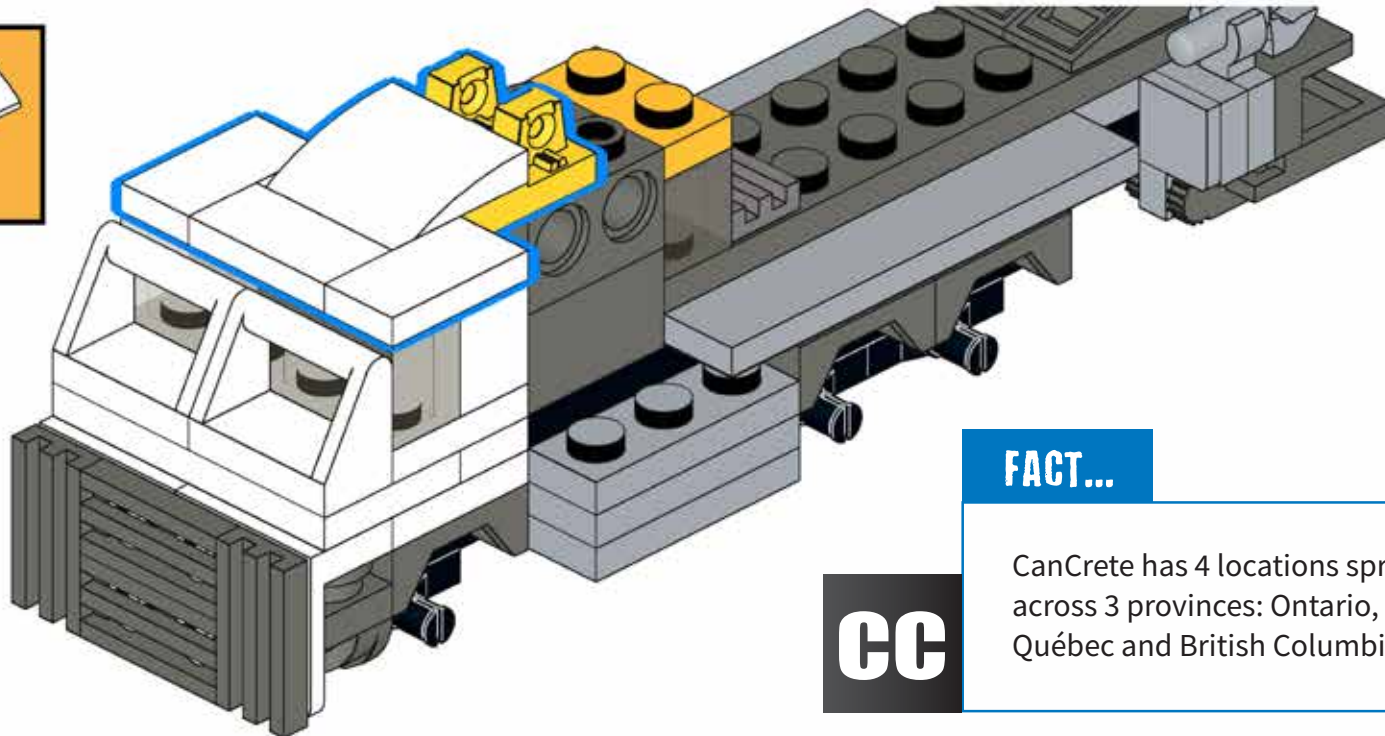
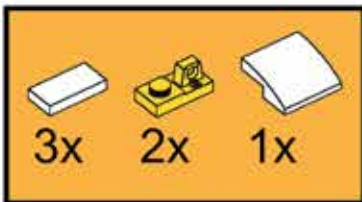

**FACT...**

CanCrete has 4 locations spread across 3 provinces: Ontario, Québec and British Columbia.





19

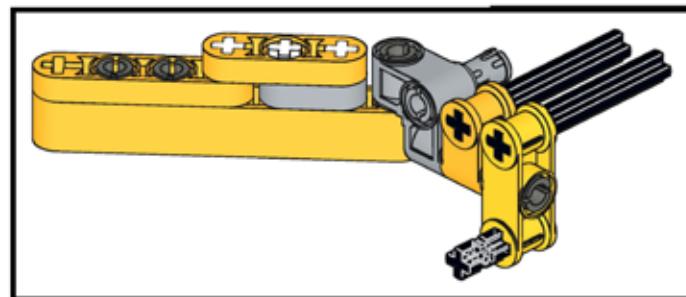
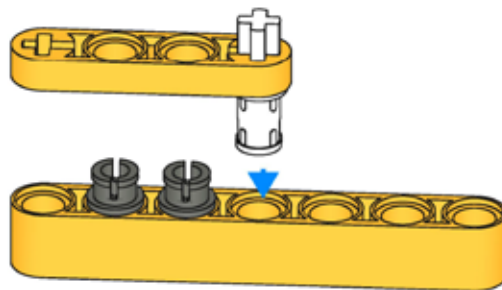
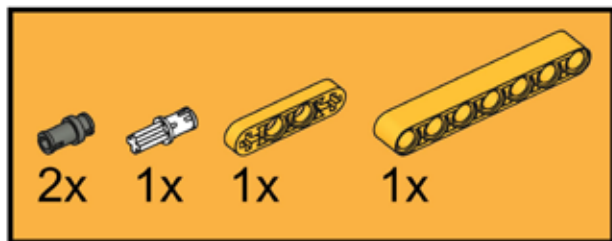

20

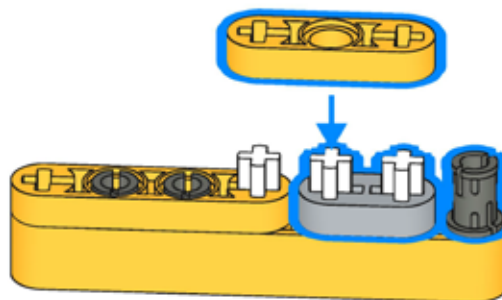
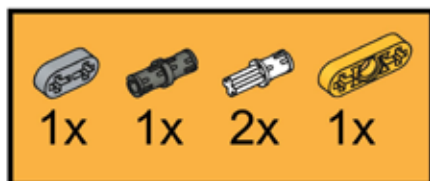

21

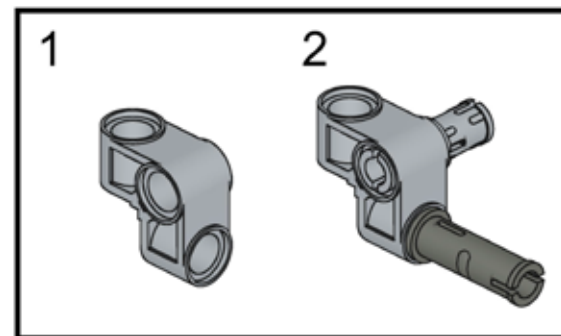
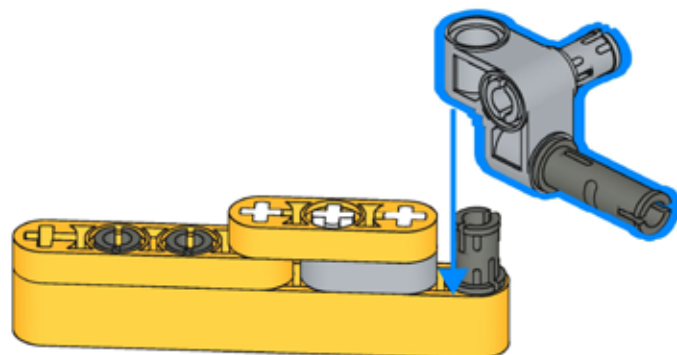
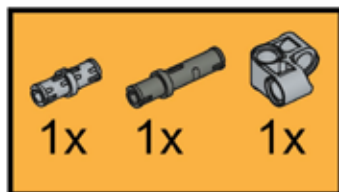

22

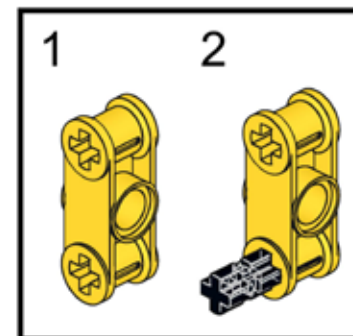
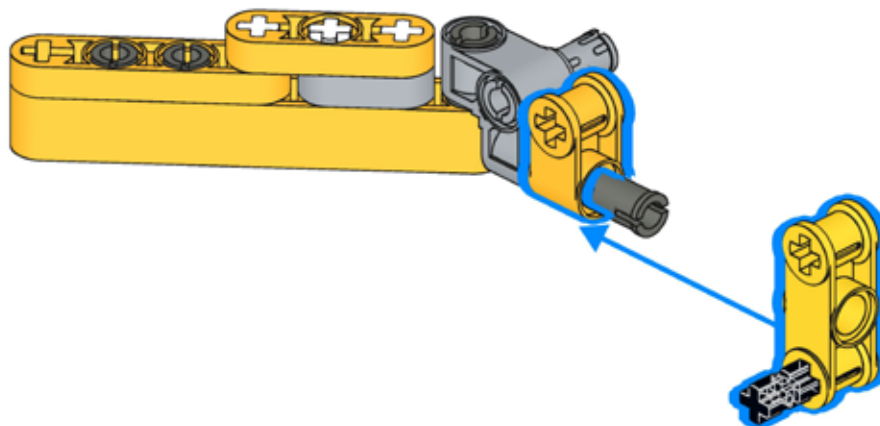
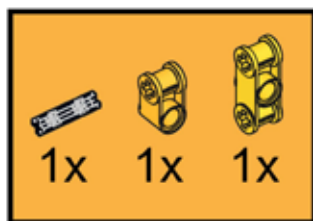

23

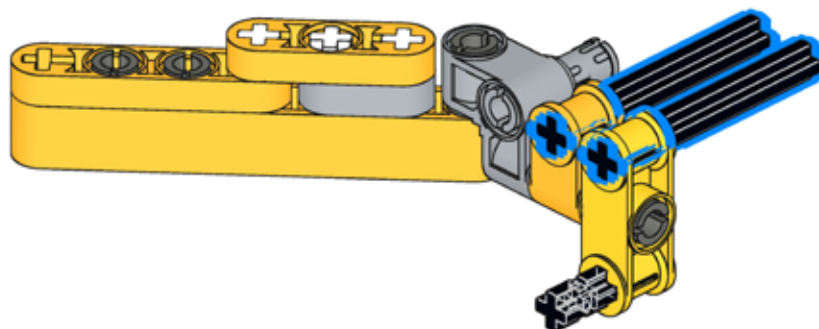

24

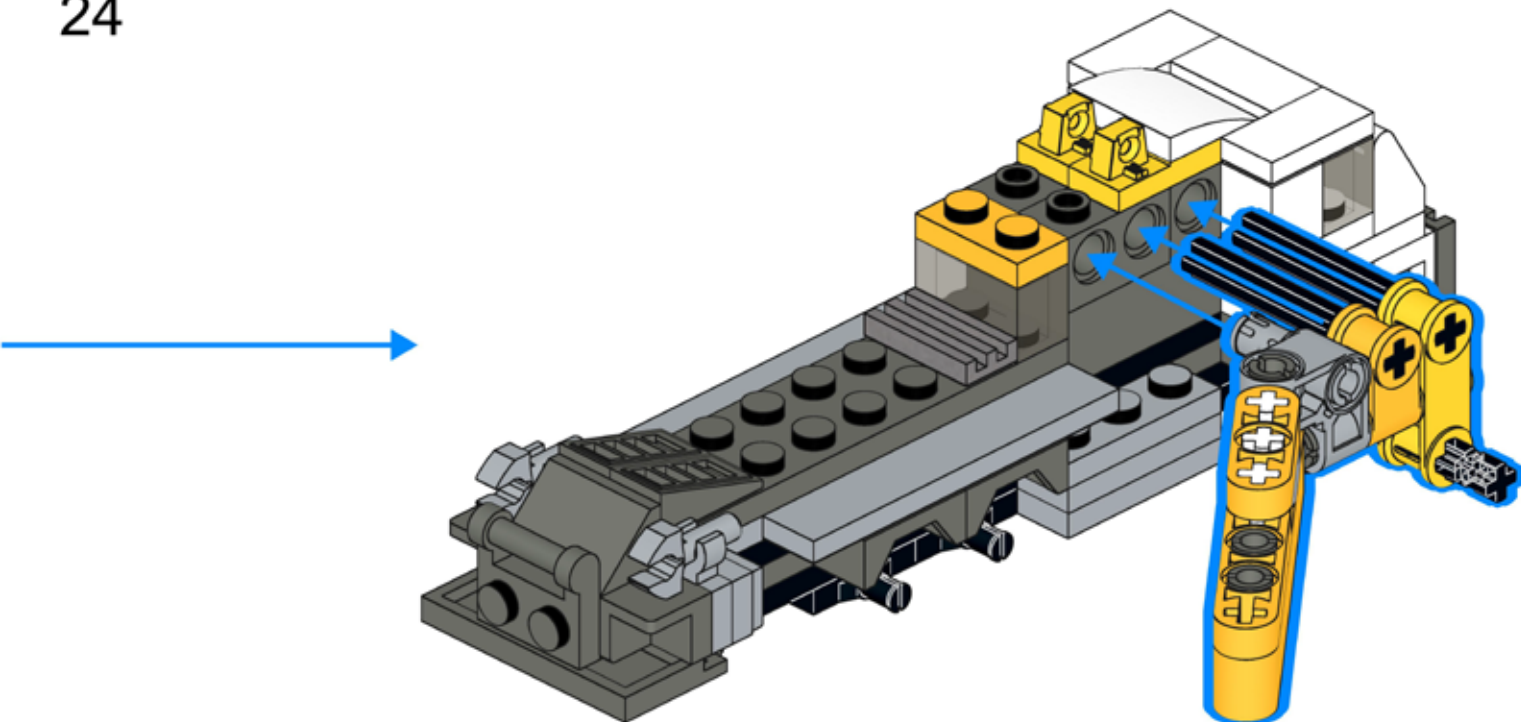

25

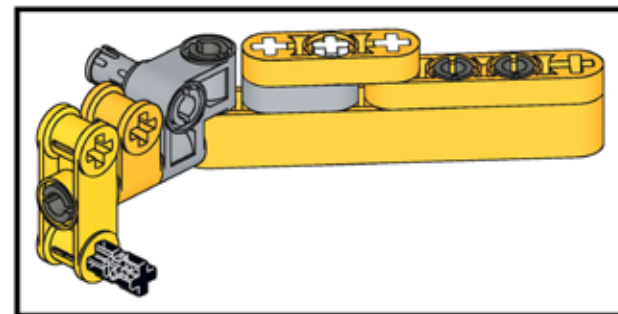
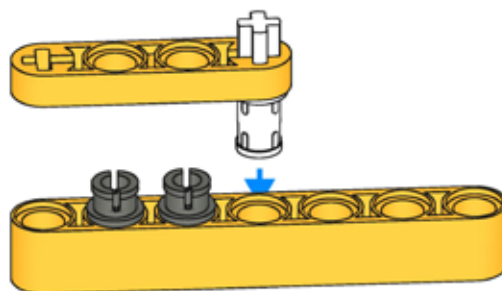
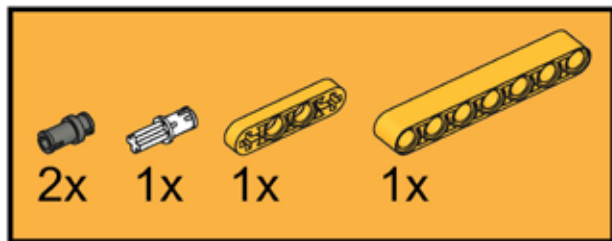

26

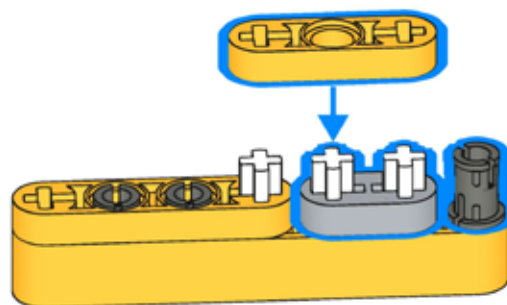
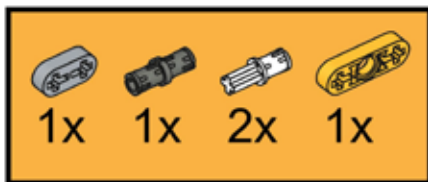

27

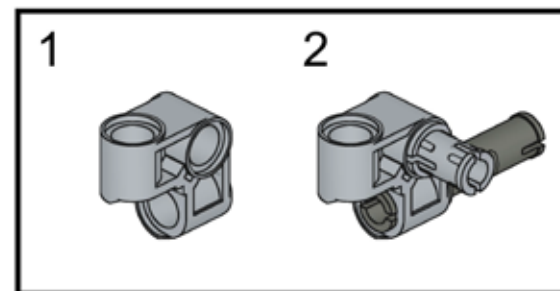
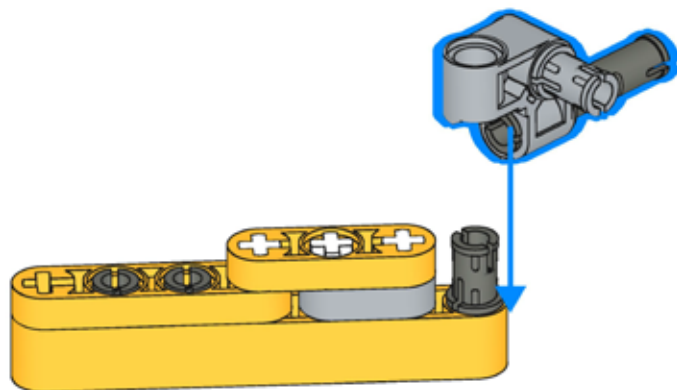
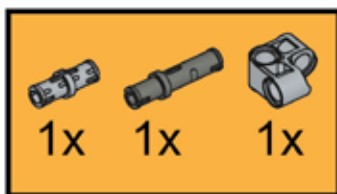

28

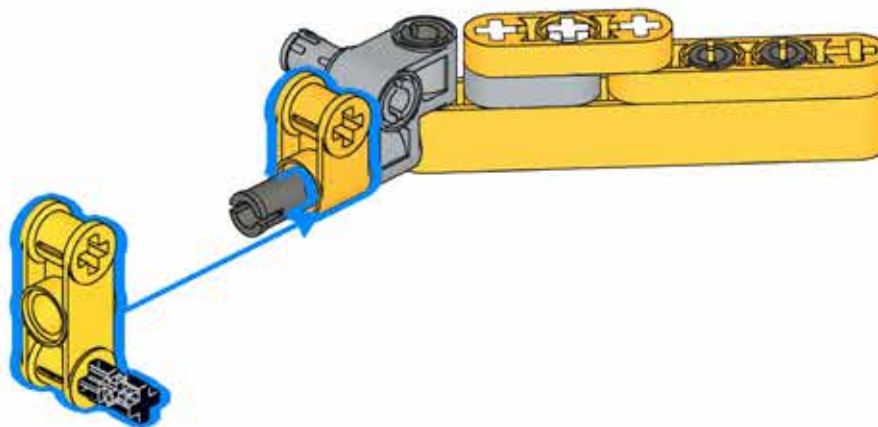
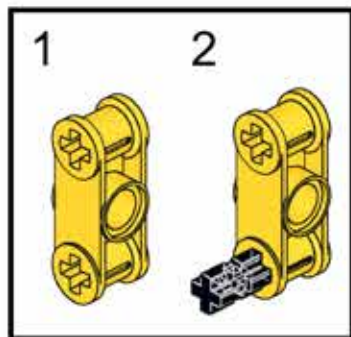
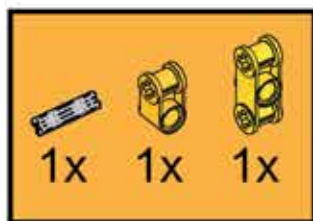

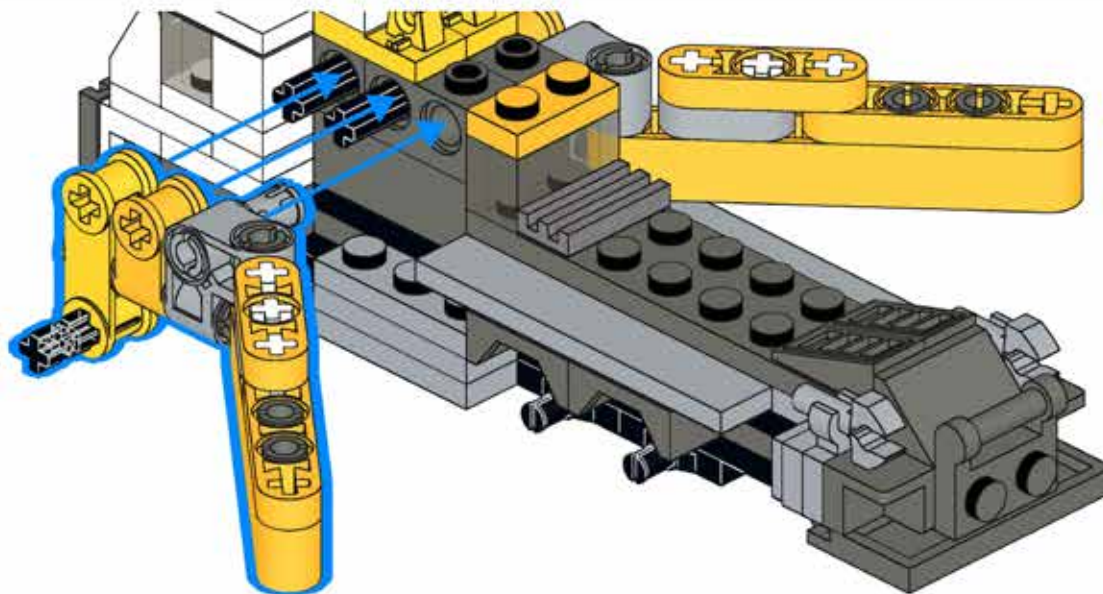

29





30

		
2x	2x	4x

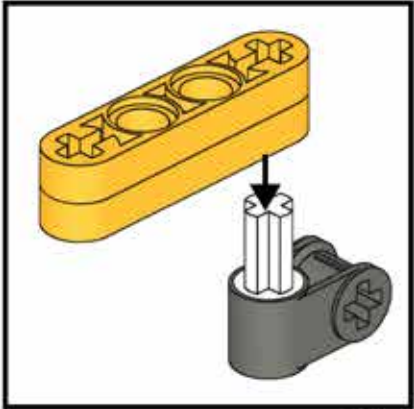
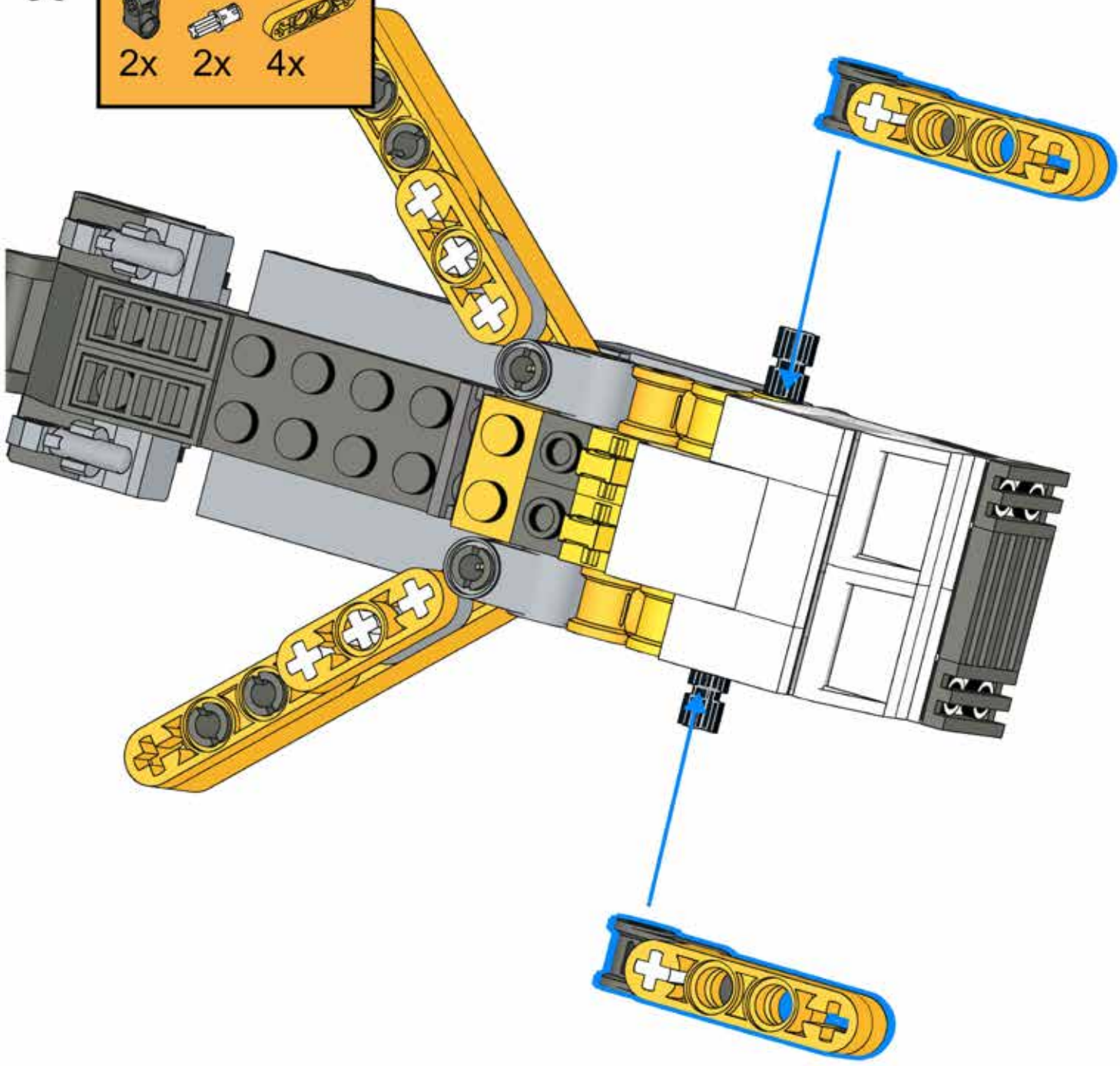

2x



31

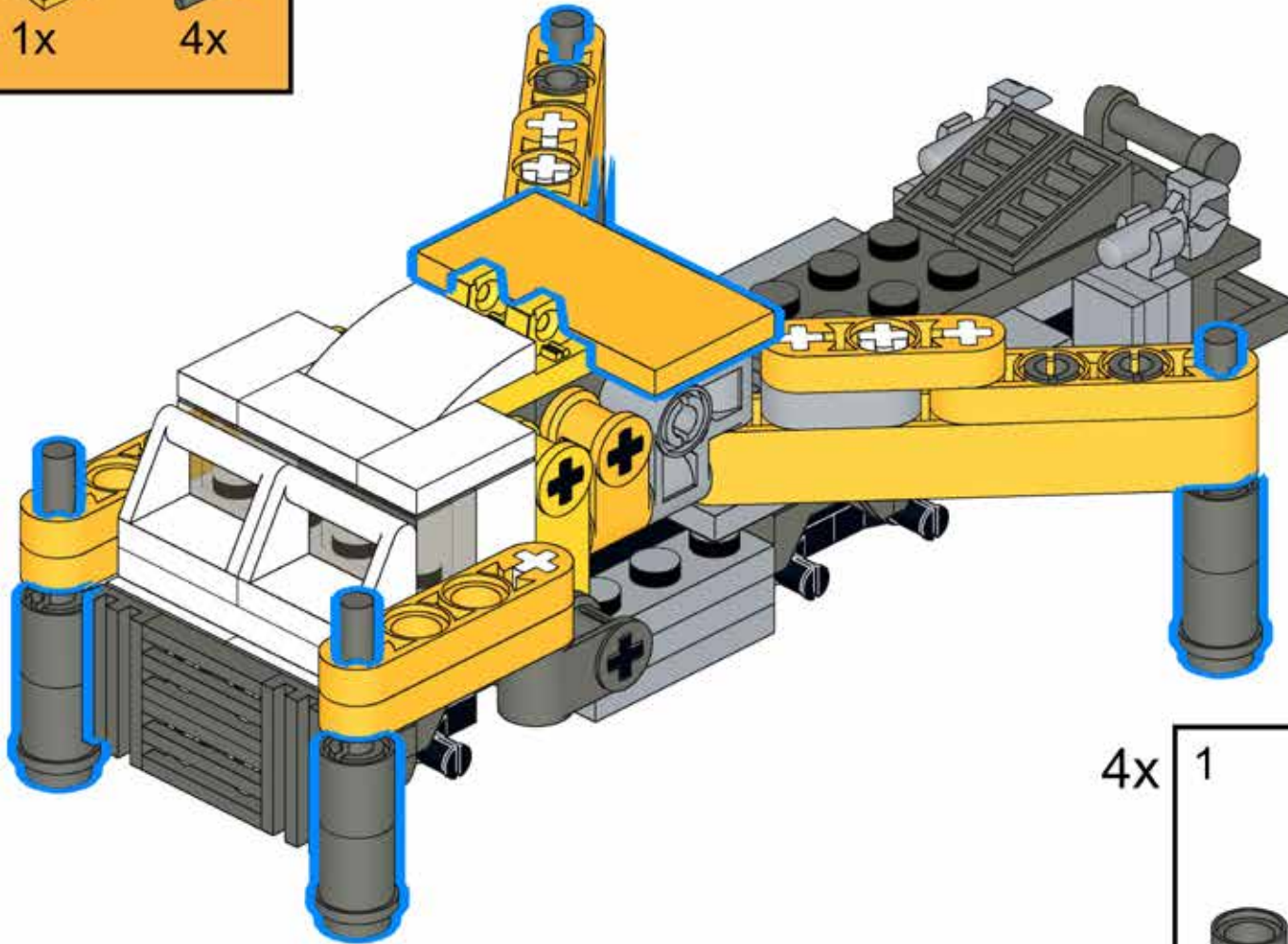
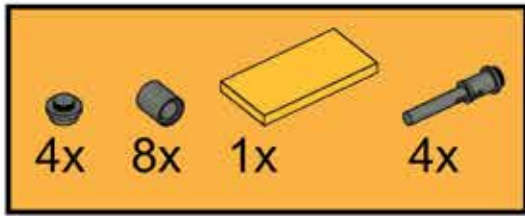

**DID YOU KNOW...**

CanCrete offers training and support on ALL equipment we carry: trailer pumps, boom pumps, placing systems, shotcrete, grouting, fireproofing, and more.

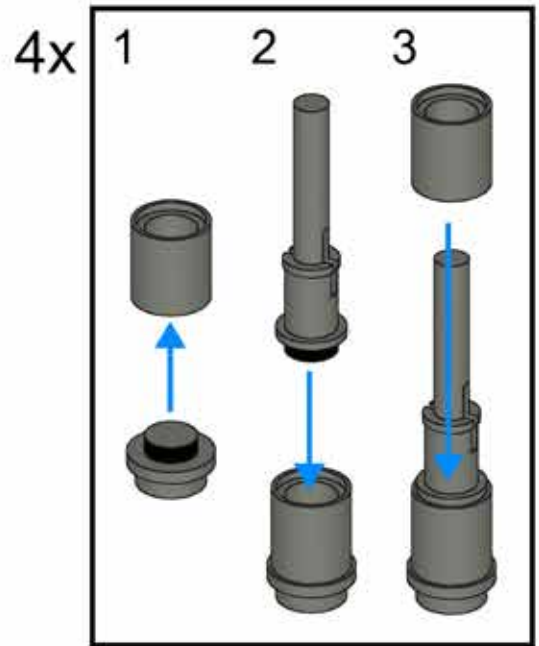

32

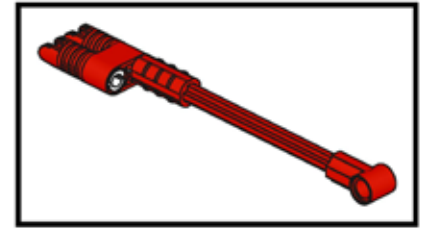
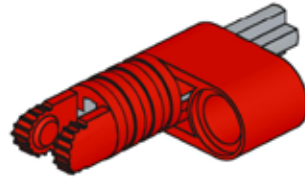
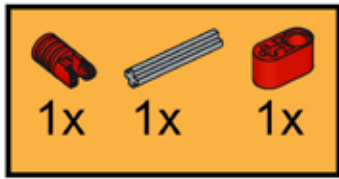

33

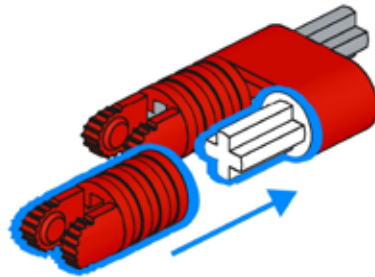
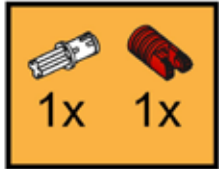

34

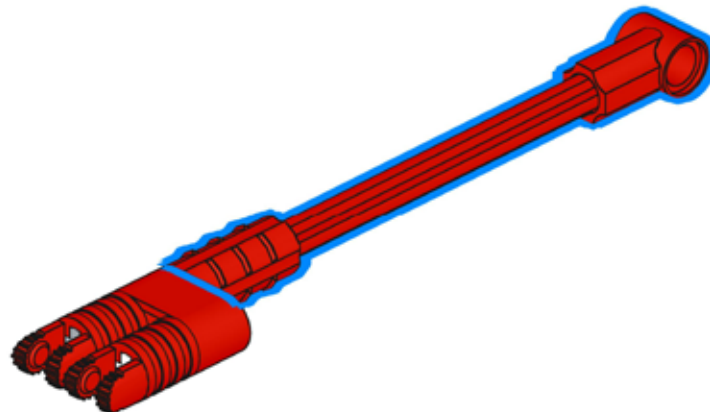
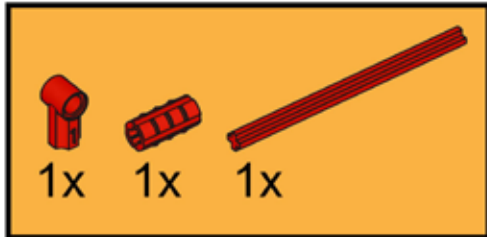

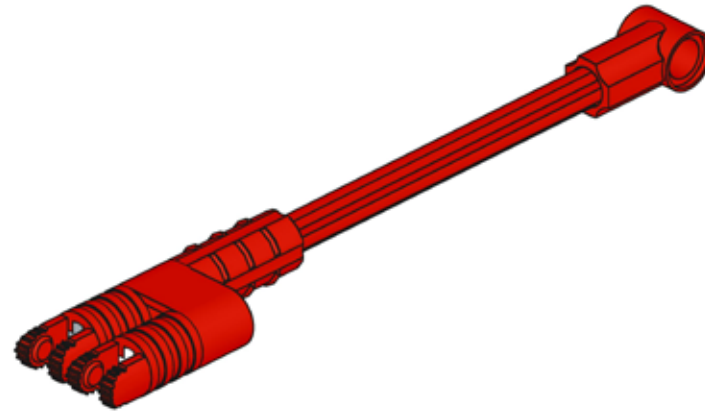
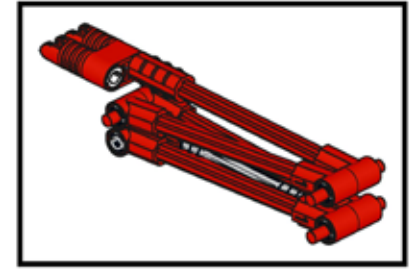

## KEEP IT RUNNING



Hydraulic Oil Filter changes ensure oil flows freely and ensures proper oil supply to the hydraulic system. This is especially important as we head into cooler outdoor temperatures, where hydraulic oil gets colder and thicker.

36

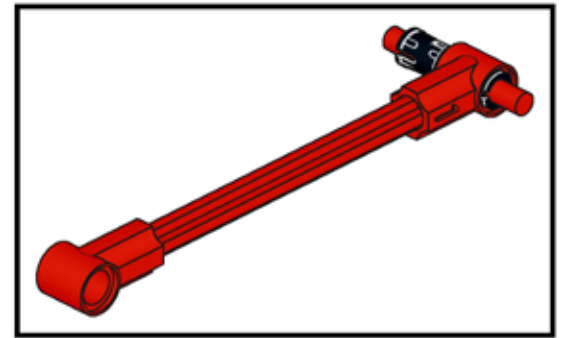
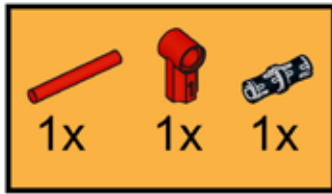

3x

37

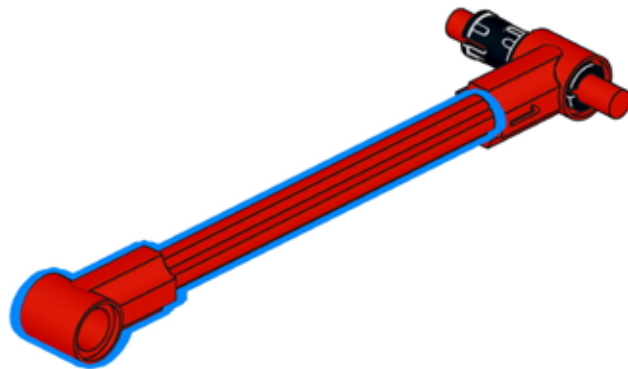
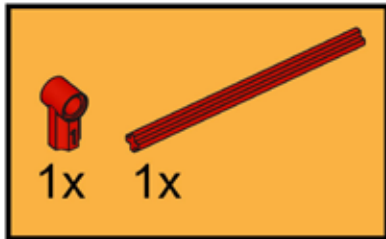

### OUR GUARANTEE

No matter what kind of project you are working on or what products you are looking for, our professional team will always go the extra mile to ensure that you have exactly what you need, when you need it.

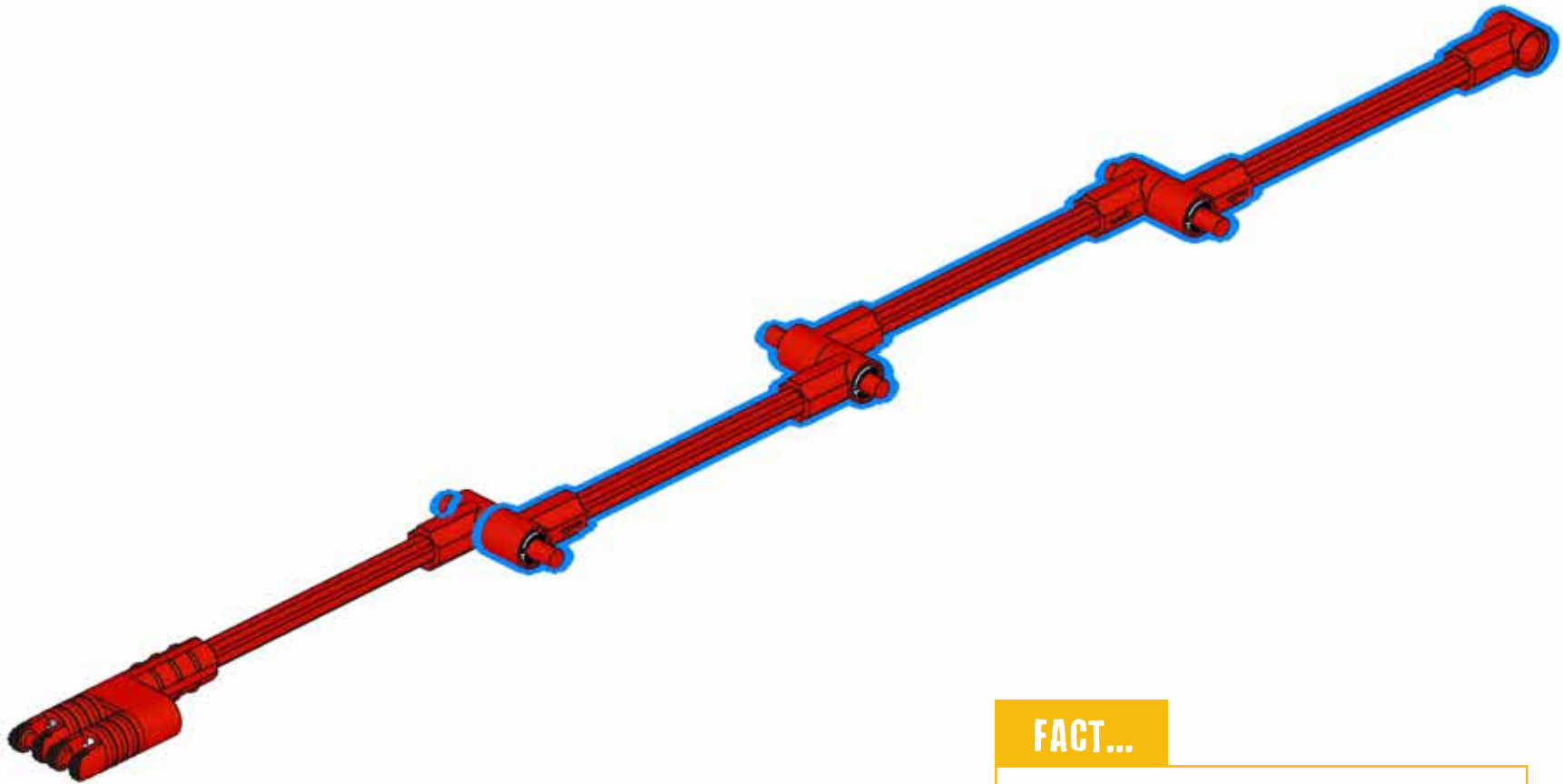

**FACT...**

Putzmeister was purchased by SANY in 2012, resulting in SANY becoming a global market leader for concrete pumps. SANY concrete pumping equipment is supported by Putzmeister and by CanCrete.



39

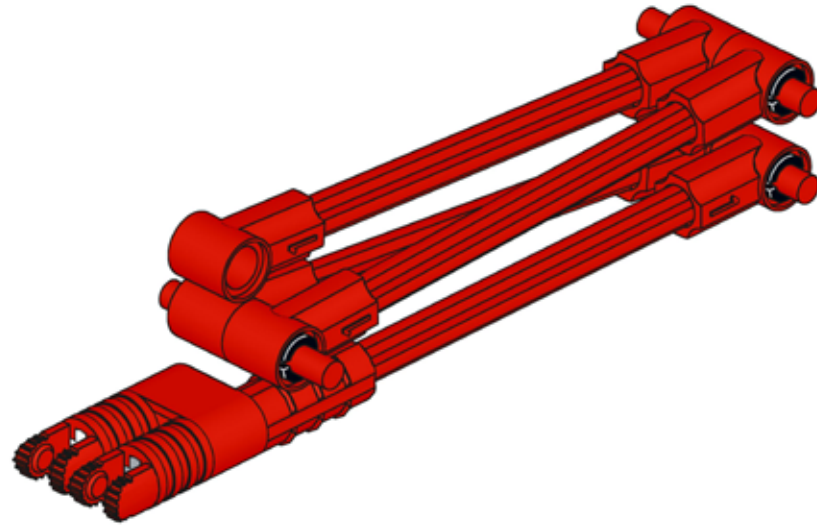

40

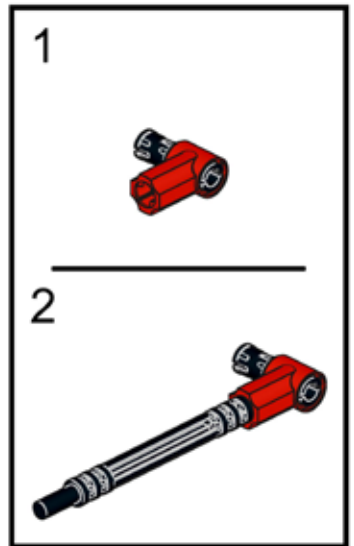
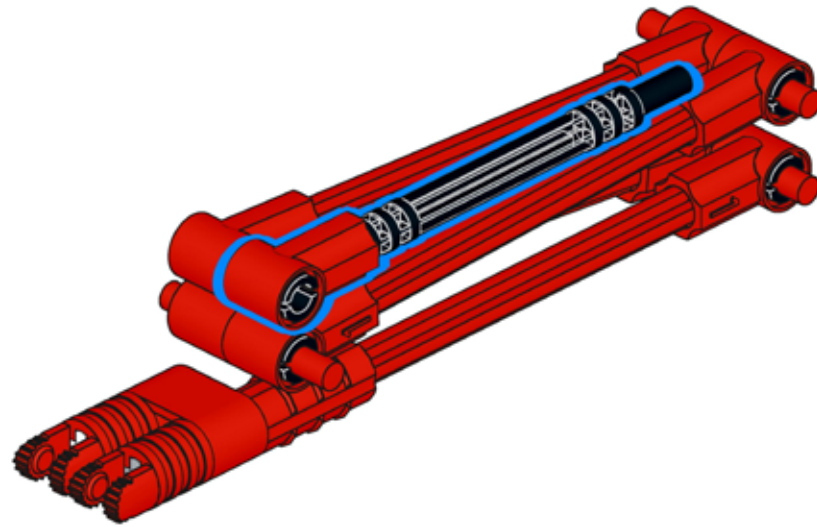
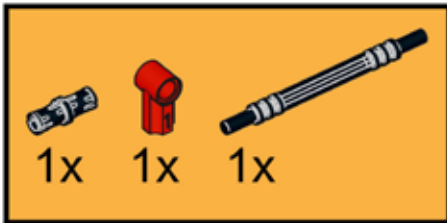



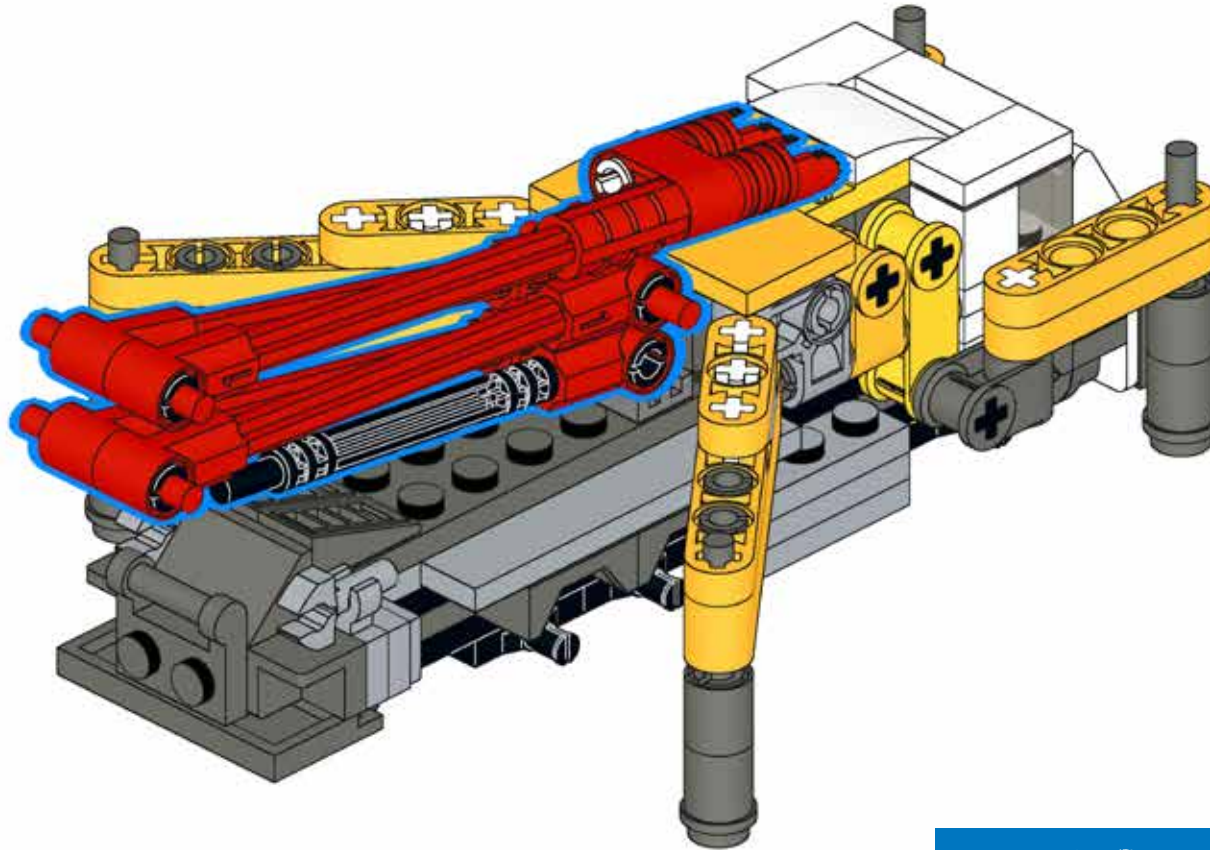

## KEEP IT RUNNING



Yearly equipment inspections ensure your equipment runs smoothly. CanCrete offers full pump inspections by our qualified team.

42



6x

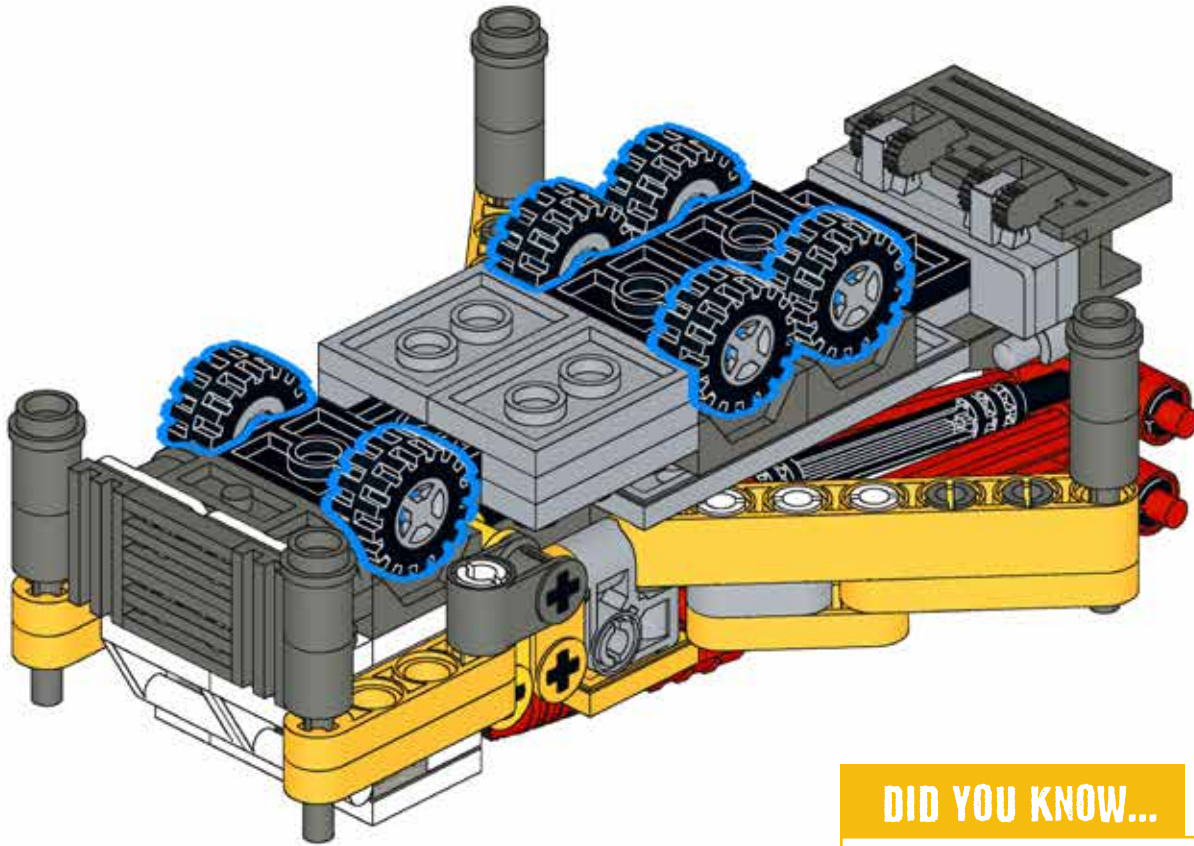

### DID YOU KNOW...

Ever wonder what BSF stands for?  
It's German (of course!)

Betonpumpe = concrete pump

S-Rohr = S-tube

Fahrbar = truck mounted



CanCrete 1x

Putzmeister 1x



**CanCrete**

[www.CanCrete.ca](http://www.CanCrete.ca)





# Disclaimer

Playwell Bricks models or designs are not official LEGO products, and are not endorsed, sponsored or authorized by the LEGO Group. It is important to note that Playwell Bricks is not a part of, nor has been endorsed by the LEGO Group. Therefore, any persons referring to our designs must understand this important point and specifically avoid using LEGO Trademarks in any and all publications, promotional materials and product web pages. Below is the official legal disclaimer that you will find on our website and packaging, and should be utilized where Playwell Bricks models or designs are promoted. When promoting Playwell Bricks models or designs, or explaining their creation, it's best to refer to these as brick building kits or models rather than labeling them as LEGO.

“LEGO and the LEGO Minifigure are trademarks of the LEGO Group, which does not sponsor, authorize or endorse this site or these products.”

# Missing Parts?

We are committed to making sure your build experience is a pleasant and enjoyable one. Occasionally errors can occur when packing your set. If you do find that parts are missing from your set, please feel free to reach out to us and we will make sure to send a replacement.

[info@playwell-bricks.com](mailto:info@playwell-bricks.com)

Play well with Playwell!

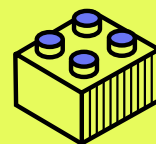

10x

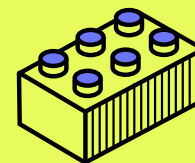

5x

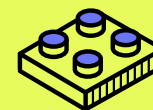

15x

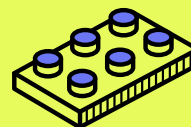

8x



10x



14x

# Behind the Build

Playwell Bricks started off with a simple mission: use the joy of LEGO® play to delight, inspire and deliver competitive advantage. We've grown to a team of like-minded individuals working with some of the best-known brands in the world, delivering incredible projects of all shapes and sizes – and we're more passionate than ever about working with our clients to create amazing builds.

Play is how human beings unleash their creativity and how we learn to ideate and innovate. It's good for team culture, great for fresh thinking and crucial for long-term competitive advantage. Playwell puts the power of LEGO® to work for you by helping your company tap into the power of creative play in unique and innovative ways.

Thank you for choosing us to be a part of your build!



Jason Pyett *Founder of Playwell Bricks*

